

Appendix B
Landscape Mitigation Planting Plans

QTY	CODE	SCIENTIFIC NAME	COMMON NAME	PLANT HEIGHT	SPEC	NOTES	GROWTH RATE	MAX HEIGHT
5	UAP	Ulmus americana 'Princeton'	Princeton Elm	2" Cal.	B&B		Medium	50-70'

5

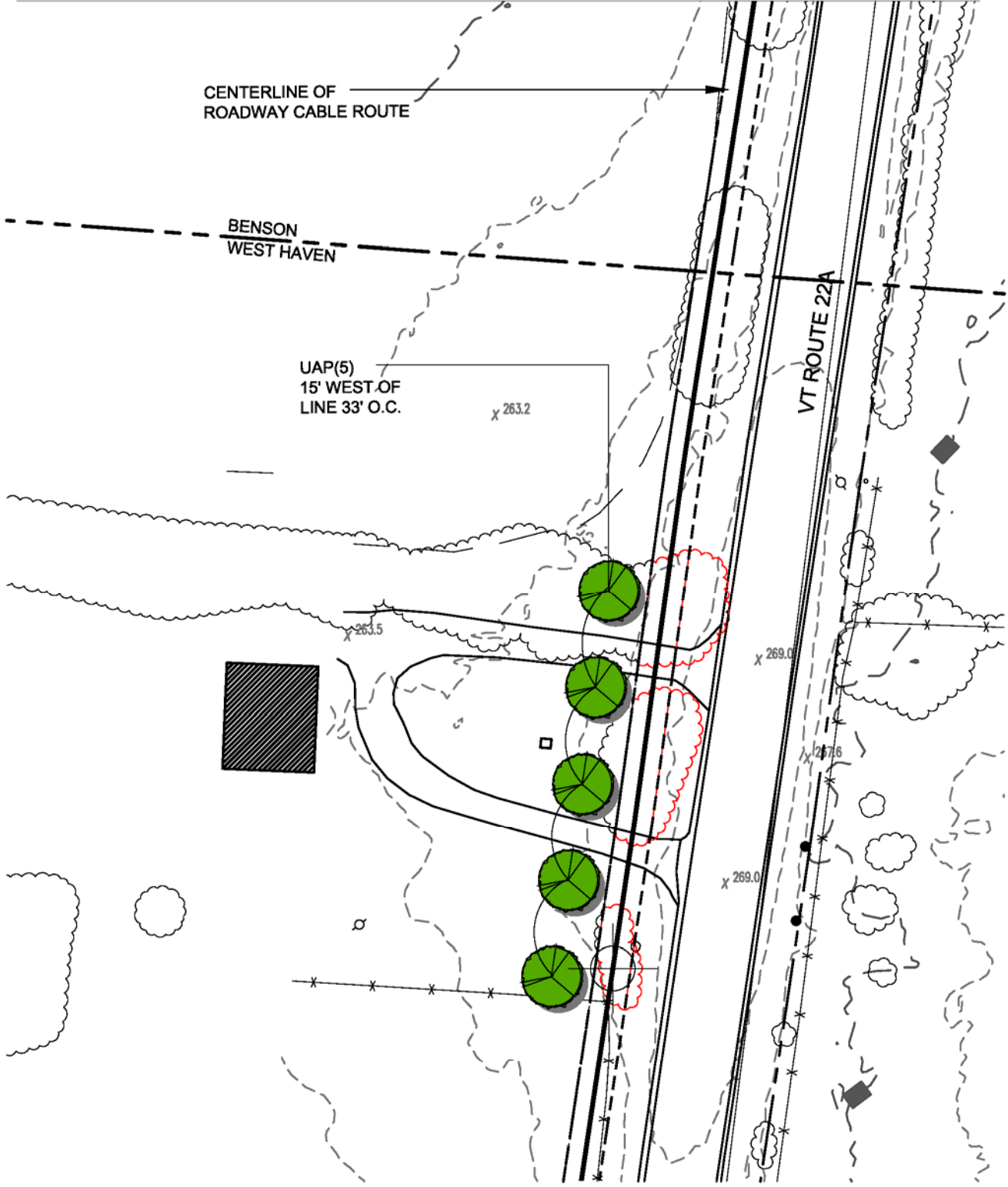

**NECPL Roadway Cable Route
Mitigation Planting Plan**

L-1 Route 22a: Benson & West Haven, VT

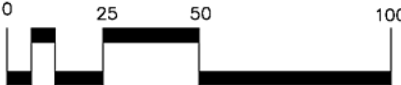

(Scale 1" = 50')



QTY	CODE	SCIENTIFIC NAME	COMMON NAME	PLANT HEIGHT	SPEC	NOTES	GROWTH RATE	MAX HEIGHT
60	PS	PINUS strobus	White Pine	6' Ht.	B&B		Fast	70-100'
60								

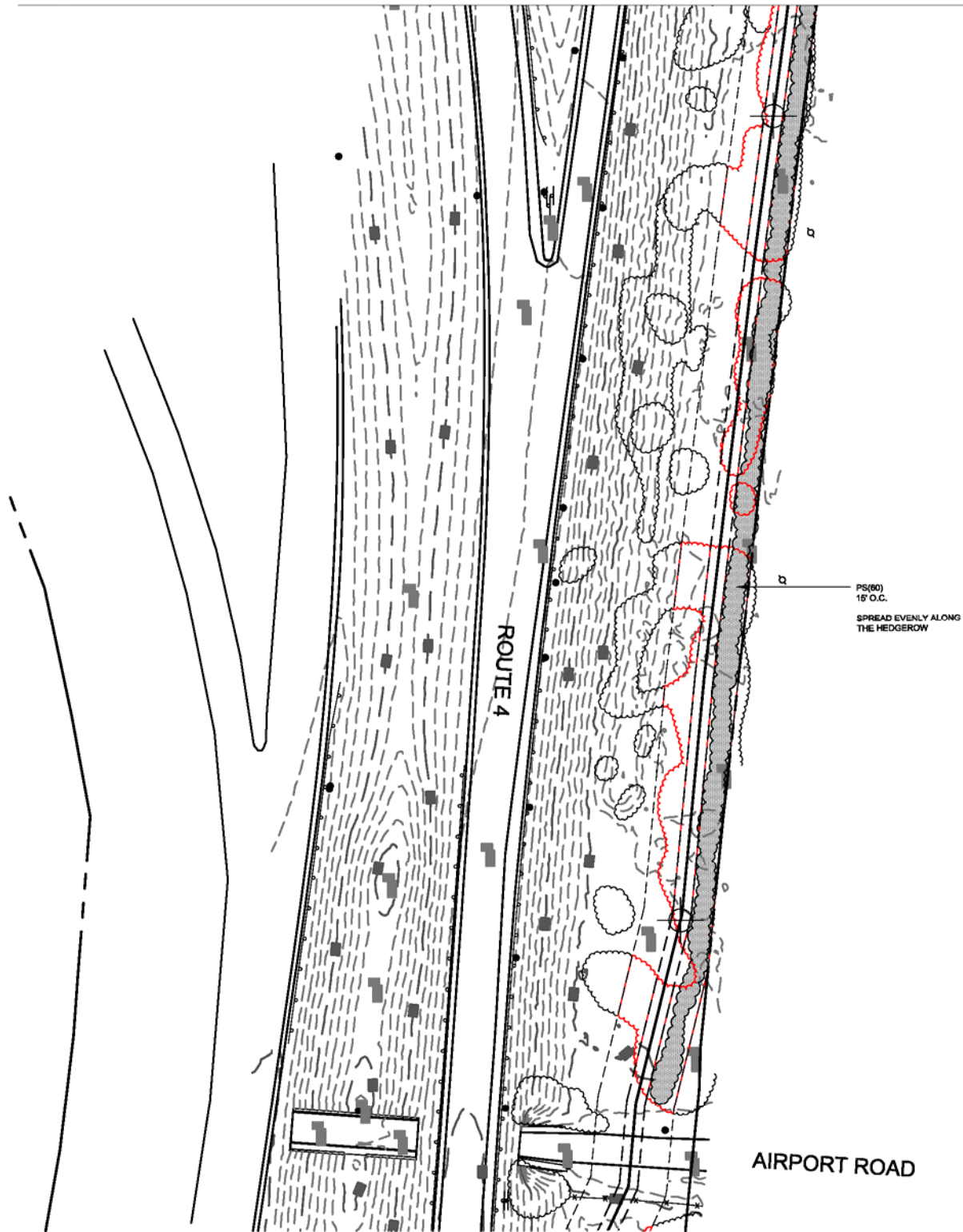

**NECPL Roadway Cable Route
Mitigation Planting Plan**

L-2 Route 4/Airport Road: Fairhaven, VT

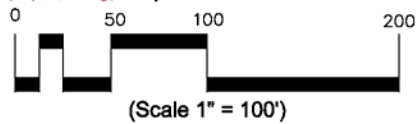

QTY	CODE	SCIENTIFIC NAME	COMMON NAME	PLANT HEIGHT	SPEC	NOTES	GROWTH RATE	MAX HEIGHT
4	PN	PINUS nigra	Austrian Pine	6' Ht.	B&B		Medium-Fast	50-70'
4								

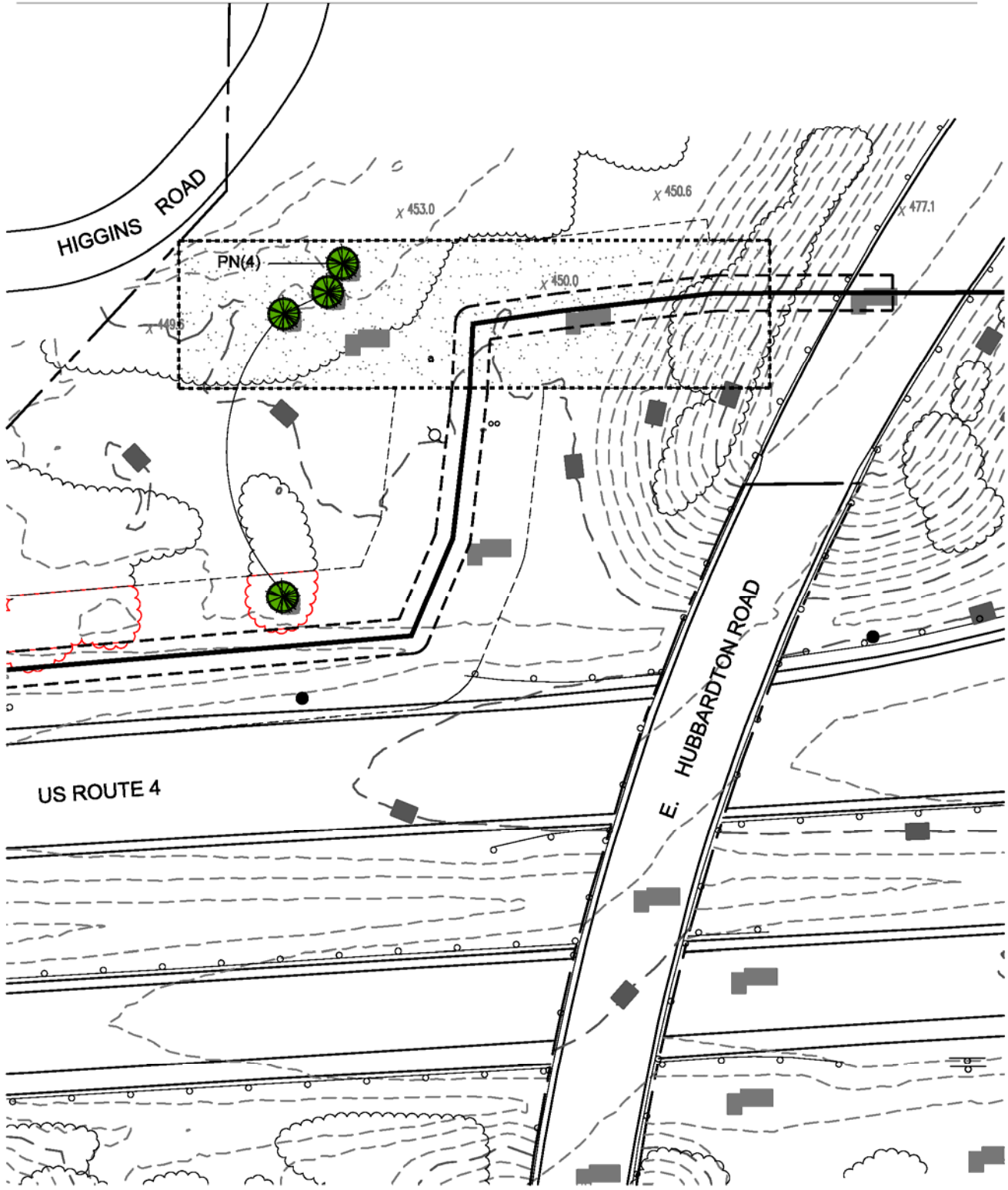

**NECPL Roadway Cable Route
Mitigation Planting Plan**
L-3 East Hubbardton-Higgins Road: Castleton, VT

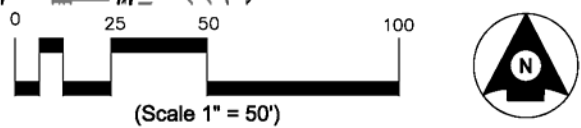

QTY	CODE	SCIENTIFIC NAME	COMMON NAME	PLANT HEIGHT	SPEC	NOTES	GROWTH RATE	MAX HEIGHT
11	ARS	ACER rubrum 'Somerset'	Somerset Red Maple	2" Cal.	B&B		Medium to Fast	30'
6	PG	PICEA glauca	White Spruce	6' Ht.	B&B		Medium	40-60'
7	PS	PINUS strobus	White Pine	6' Ht.	B&B		Fast	70-100'

24

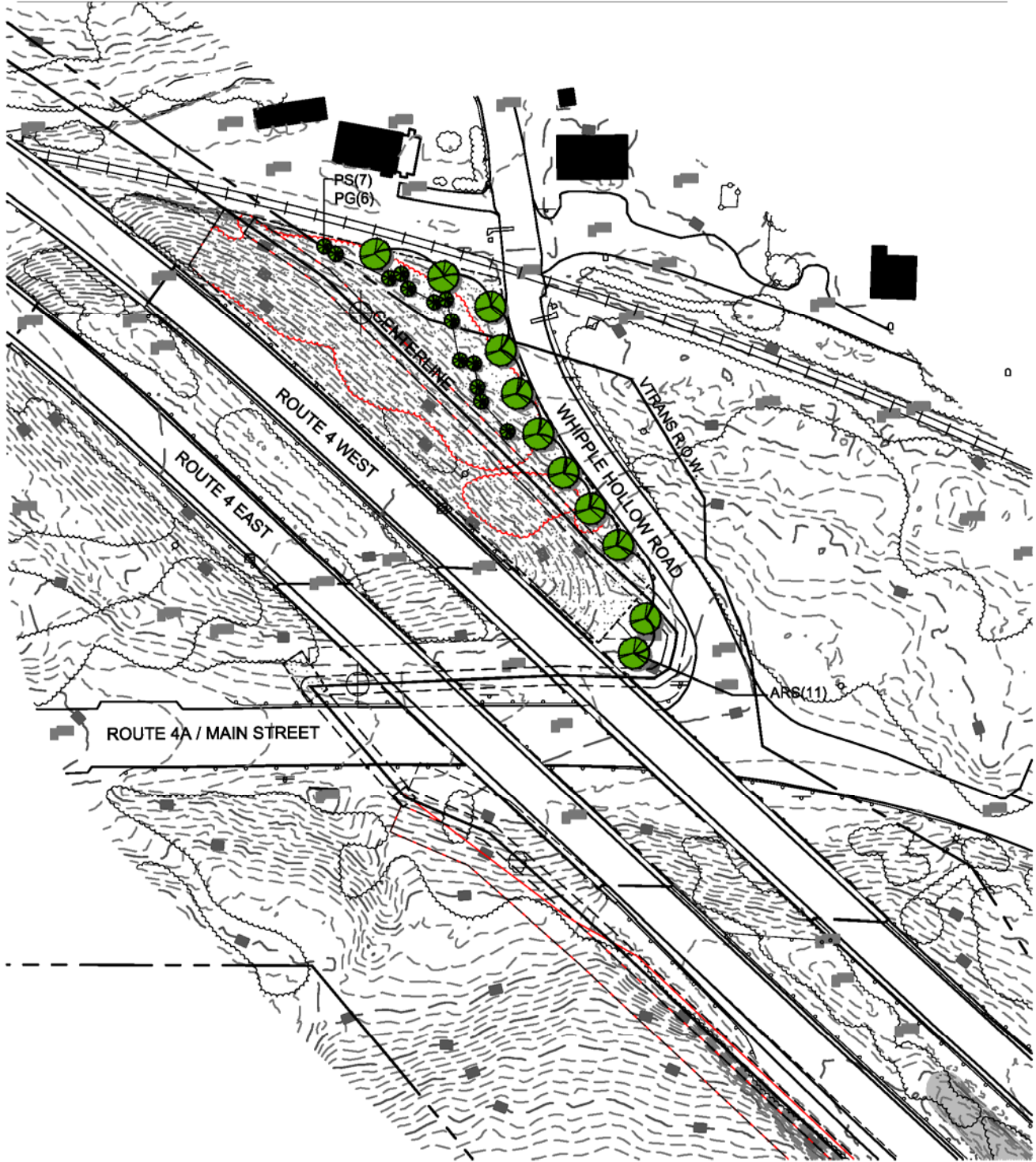

**NECPL Roadway Cable Route
Mitigation Planting Plan**

L-4 Route 4a & Whipple Hollow Road: West Rutland, VT

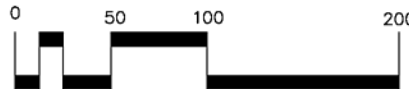

(Scale 1" = 100')



QTY	CODE	SCIENTIFIC NAME	COMMON NAME	PLANT HEIGHT	SPEC	NOTES	GROWTH RATE	MAX HEIGHT
5	ARS	ACER rubrum 'Somerset'	Somerset Red Maple	2" Cal.	B&B		Medium to Fast	30'

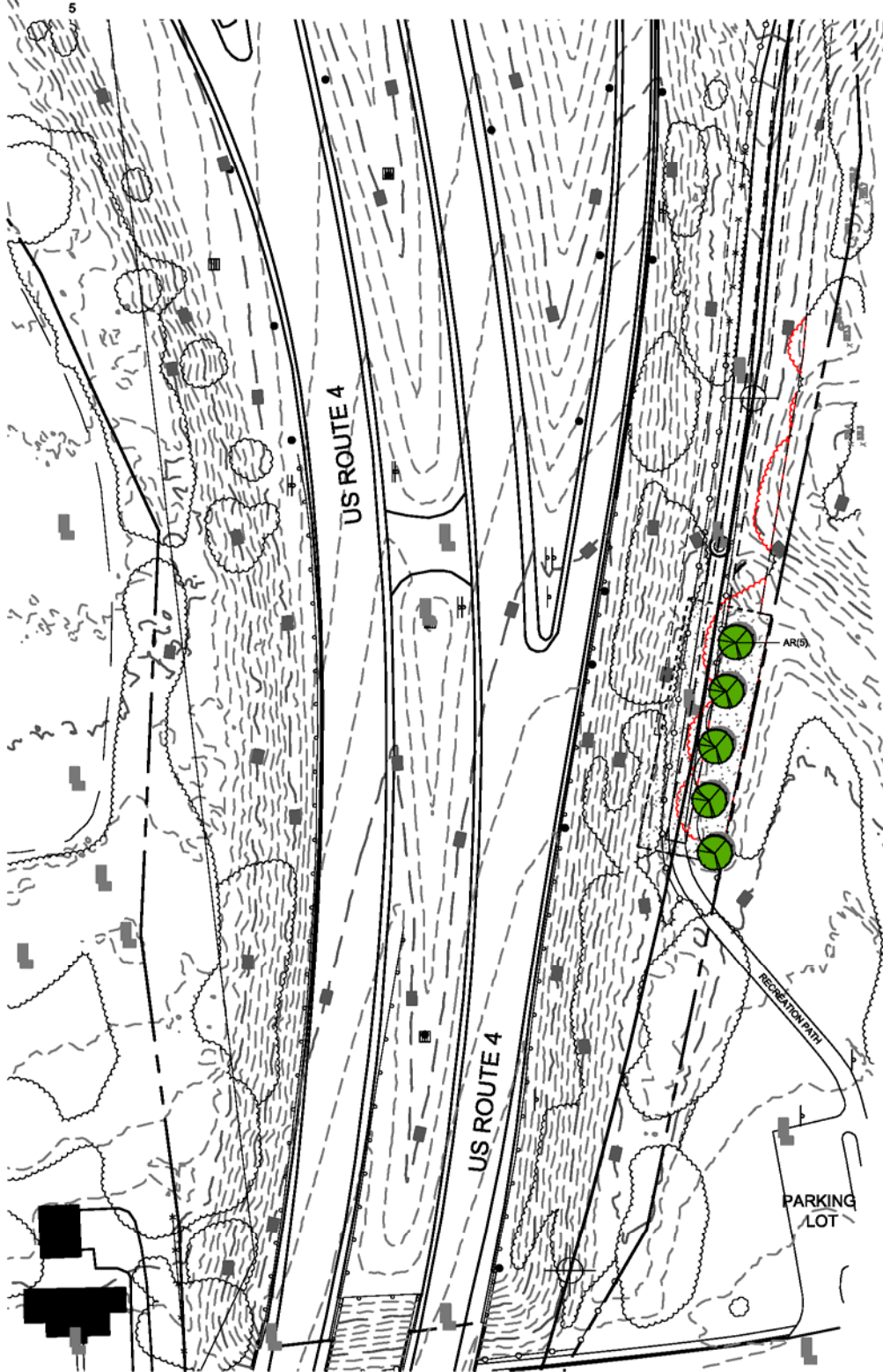

**NECPL Roadway Cable Route
Mitigation Planting Plan**
L-5 West Rutland Rec Path: West Rutland, VT

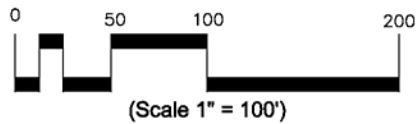

QTY	CODE	SCIENTIFIC NAME	COMMON NAME	PLANT HEIGHT	SPEC	NOTES	GROWTH RATE	MAX HEIGHT
3	ARS	ACER rubrum 'Somerset'	Somerset Red Maple	2" Cal.	B&B		Medium to Fast	30'
3	AL	AMELANCHIER laevis	Alleghany Serviceberry	6' Ht.	B&B		Medium	20-25'
7	PG	PICEA glauca	White Spruce	6' Ht.	B&B		Medium	40-60'
10	TO	THUJA occidentalis	White Cedar	5' Ht.	B&B		Medium	20-30'

23



**NECPL Roadway Cable Route
Mitigation Planting Plan**
L-6 Route 7 South of Cold River: Clarendon, VT

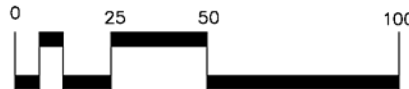

(Scale 1" = 50')



QTY	CODE	SCIENTIFIC NAME	COMMON NAME	PLANT HEIGHT	SPEC	NOTES	GROWTH RATE	MAX HEIGHT
1	ARS	ACER rubrum 'Somerset'	Somerset Red Maple	2" Cal.	B&B		Medium to Fast	30'
3	AB	ABIES balsamea	Balsam Fir	6' Ht.	B&B		Slow	30-40'
3	AM	ARONIA melanocarpa	Black Chokeberry	36" Ht.	No. 5 Cont.		Medium	3-6'

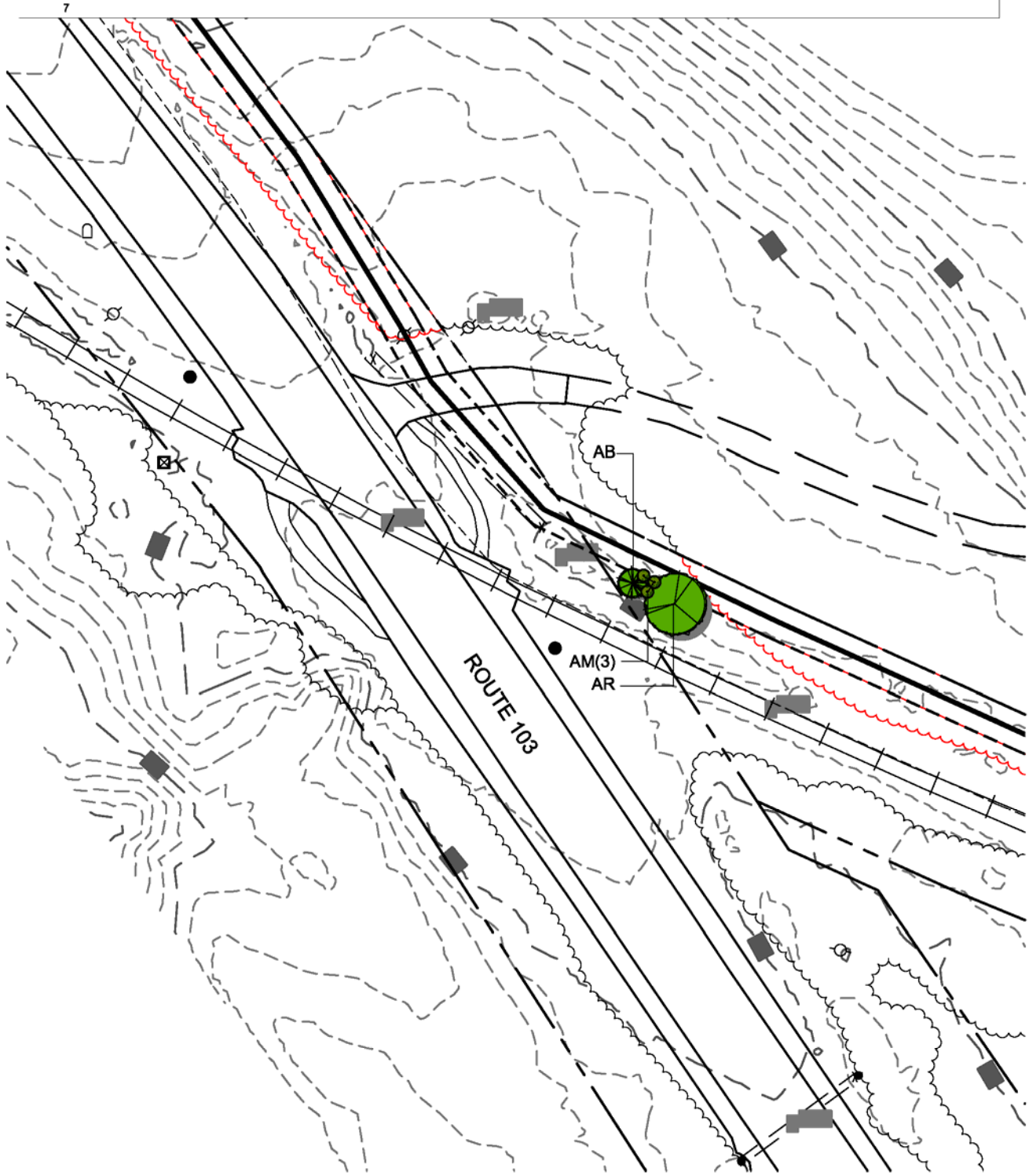

**NECPL Roadway Cable Route
Mitigation Planting Plan**
L-7 Route 103 & Railroad Crossin: Shrewsbury, VT

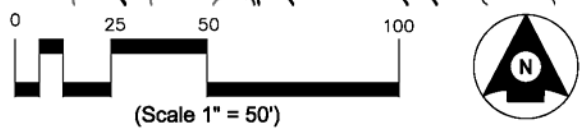

QTY	CODE	SCIENTIFIC NAME	COMMON NAME	PLANT HEIGHT	SPEC	NOTES	GROWTH RATE	MAX HEIGHT
3	AB	ABIES balsamea	Balsam Fir	6' Ht.	B&B		Slow	30-40'
6	ARS	ACER rubrum 'Somerset'	Somerset Red Maple	2" Cal.	B&B		Medium to Fast	30'
10	PG	PICEA glauca	White Spruce	6' Ht.	B&B		Medium	40-60'
15	PS	PINUS strobus	White Pine	6' Ht.	B&B		Fast	70-100'
10	TO	THUJA occidentalis	White Cedar	5' Ht.	B&B		Medium	20-30'

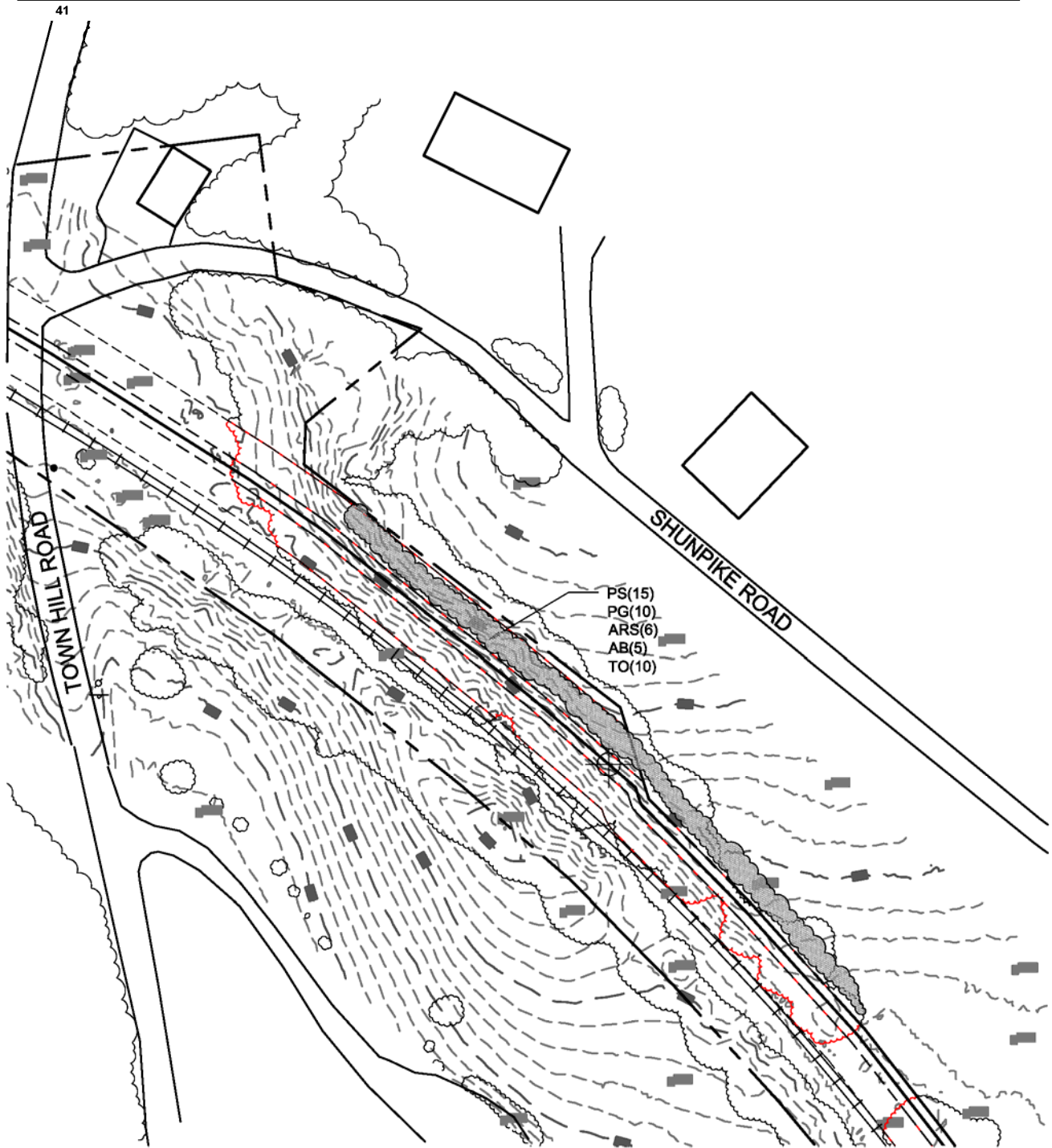

**NECPL Roadway Cable Route
Mitigation Planting Plan**
L-8 Townhill Road: Shrewsbury, VT

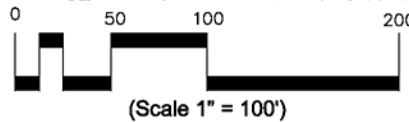

QTY	CODE	SCIENTIFIC NAME	COMMON NAME	PLANT HEIGHT	SPEC	NOTES	GROWTH RATE	MAX HEIGHT
2	ARS	ACER rubrum 'Somerset'	Somerset Red Maple	2" Cal.	B&B		Medium to Fast	30'
5	PS	PINUS strobus	White Pine	6' Ht.	B&B		Fast	70-100'



**NECPL Roadway Cable Route
Mitigation Planting Plan
L-9 Route 103: Wallingford, VT**

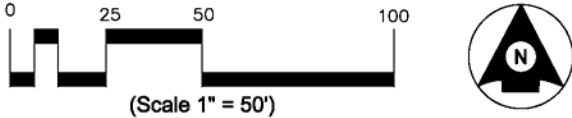

QTY	CODE	SCIENTIFIC NAME	COMMON NAME	PLANT HEIGHT	SPEC	NOTES	GROWTH RATE	MAX HEIGHT
3	ARS	ACER rubrum 'Somerset'	Somerset Red Maple	2" Cal.	B&B		Medium to Fast	30'
1	CO	CELTIS occidentalis	Common Hackberry	2" Cal.	B&B		Medium to Fast	40'

4

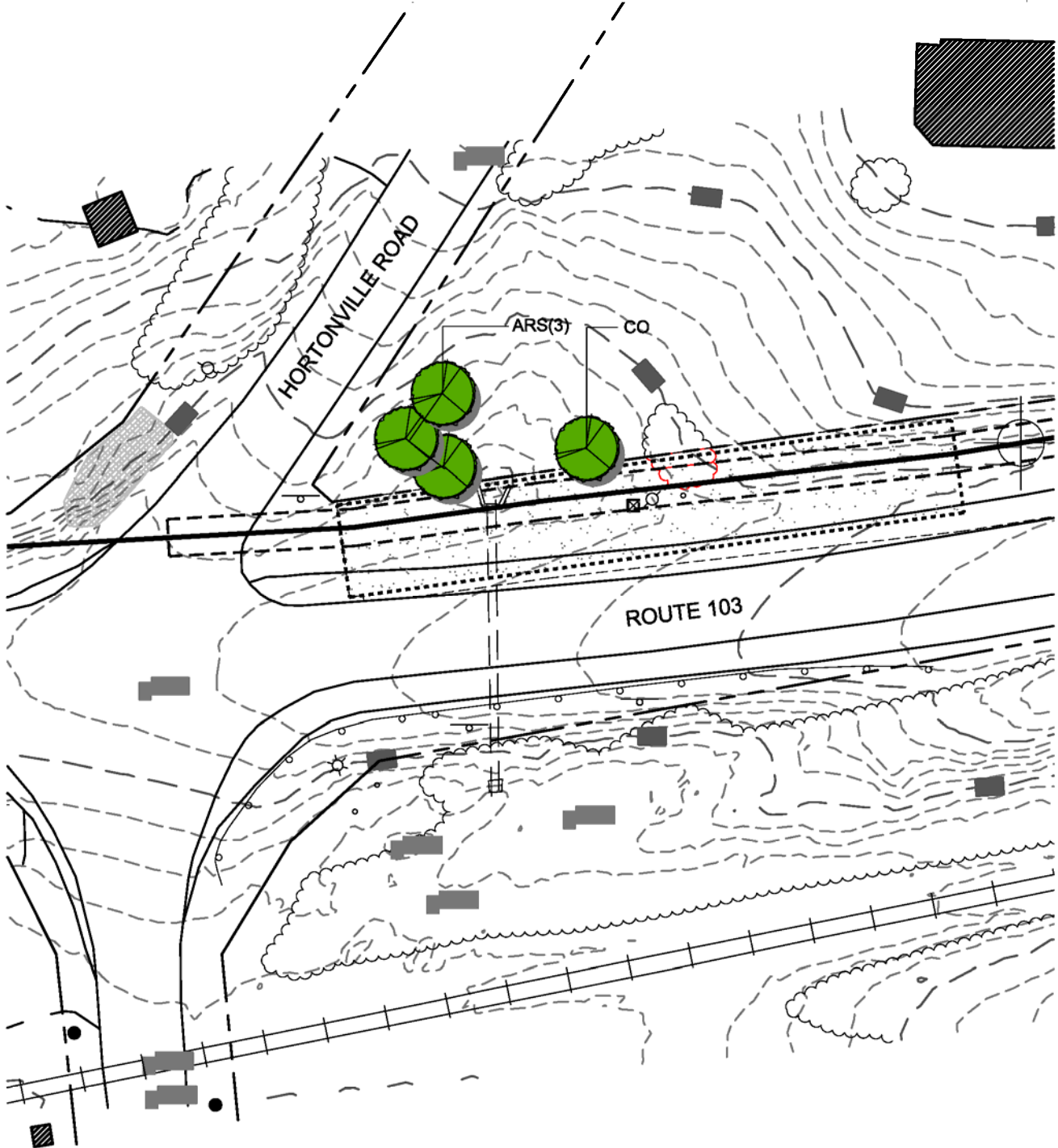

**NECPL Roadway Cable Route
Mitigation Planting Plan**
L-10 Route 103-Hortonville Road: Mount Holly, VT

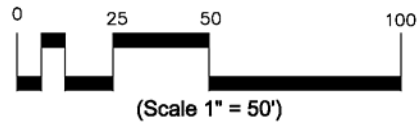

QTY	CODE	SCIENTIFIC NAME	COMMON NAME	PLANT HEIGHT	SPEC	NOTES	GROWTH RATE	MAX HEIGHT
2	ARS	ACER rubrum 'Somerset'	Somerset Red Maple	2" Cal.	B&B		Medium to Fast	30'
2	AL	AMELANCHIER laevis	Alleghany Serviceberry	6' Ht.	B&B	multi-stem, 3-4 stems	Medium	20-25'
8	BN	BETULA nigra	River Birch	10' Ht.	B&B	multi-stem, 3-4 stems	Medium to Fast	30-50'
18	PA	PICEA abies	Norway Spruce	6' Ht.	B&B		Medium	40 - 60'
20	TO	THUJA occidentalis	White Cedar	6' Ht.	B&B		Medium to Fast	20-25'
50								

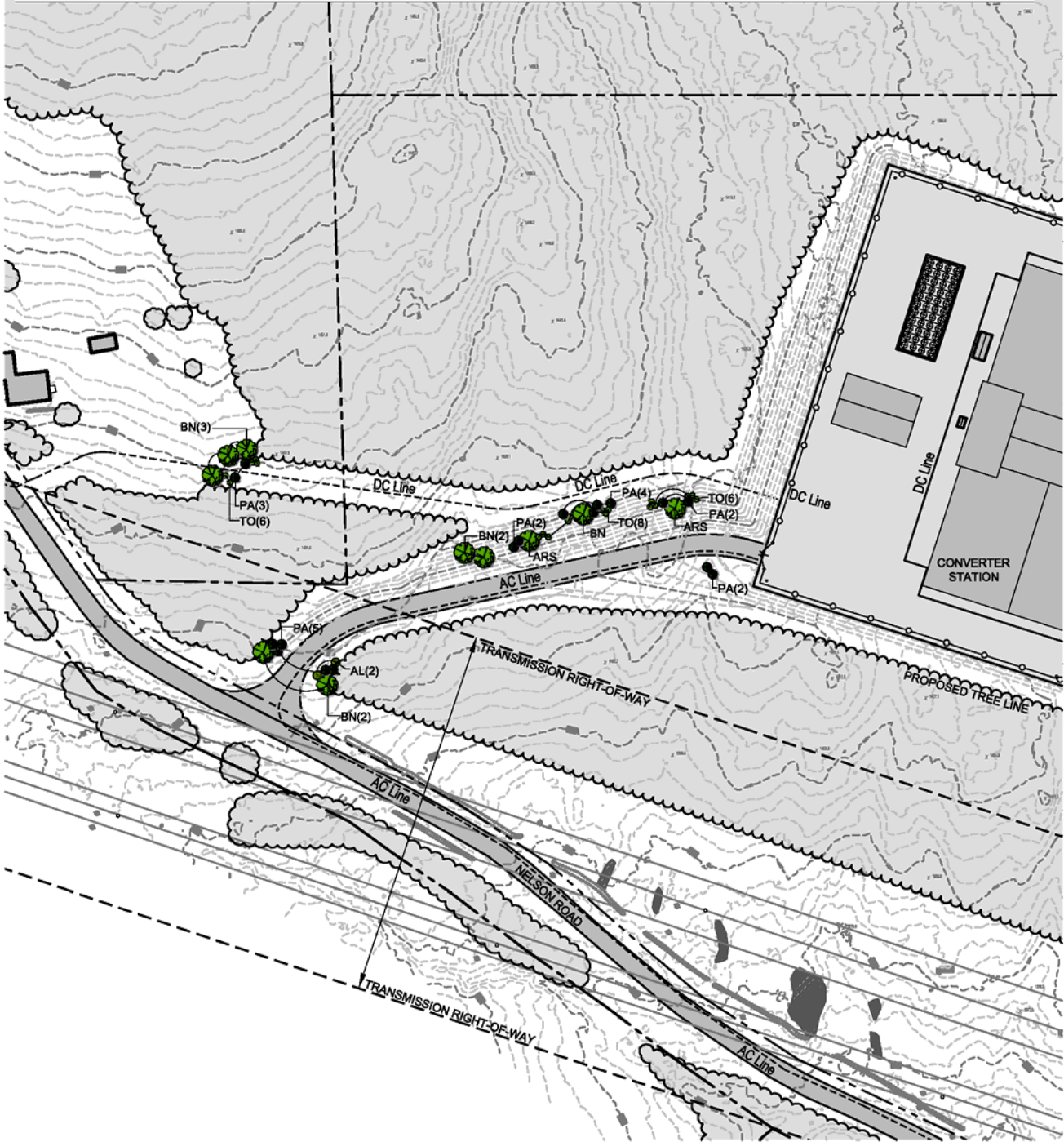

NECPL Converter Station
Mitigation Planting Plan
 L-11 Converter Station: Ludlow, VT

